

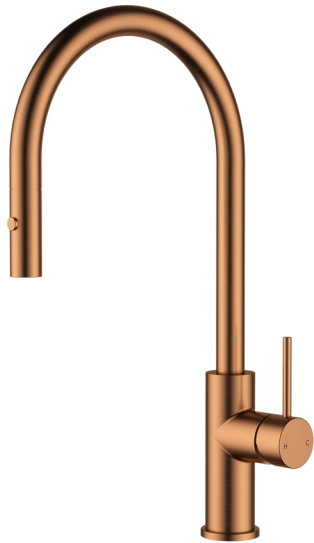

PLC10016SS - Sink Mixer  
- Brushed Stainless Steel

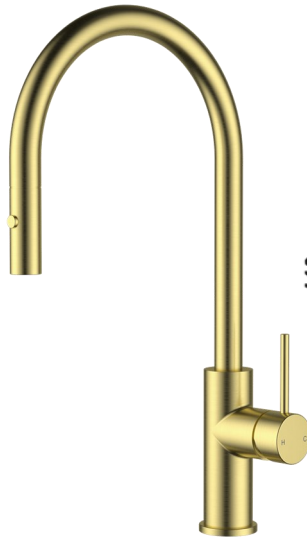

PCL1016SS-BC - Sink Mixer  
- Brushed Copper



PLC1016SS-BG - Sink Mixer  
- Brushed Gold

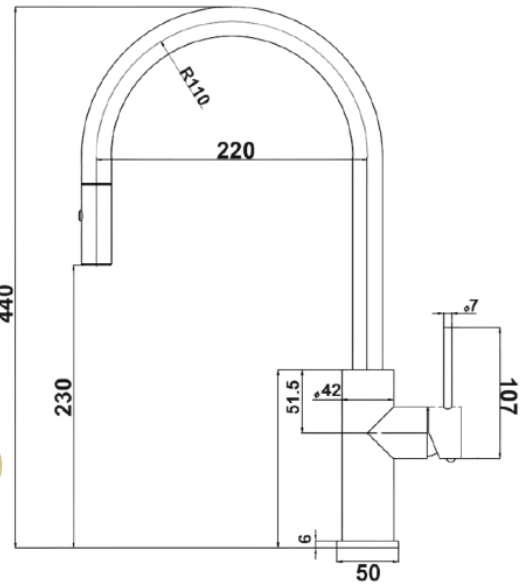

PLC1016SS-CH - Sink Mixer  
- Chrome



PCL1016SS-GM - Sink Mixer  
- Gunmetal



PCL1016SS-MB - Sink Mixer  
- Matt Black



## OTUS SLIMLINE S/STEEL PULL-OUT SINK MIXER

PLC1016SS\*

**FINISH:** See Above

**MATERIAL:** SS304 Stainless Steel

**WORKING PRESSURE:** 150-500kpa

**OPERATING TEMPERATURE:** 1°C—80°C

**WELS LICENCE:** 0175

**WELS:** 6 Star 4.5L Per Min, Reg No. T45936

**CARTRIDGE TYPE:** 35mm Cartridge

**WARRANTY:**

15 Years Cartridge only

5 Year replacement product and parts

1 Year replacement parts and labour

**Maintenance and Care**

- Do not use harsh detergents or products that contain chloride & halides.
- Do not use abrasive, cream or citrus based cleaners or hydrochloric acid.
- Surface should be cleaned only with a mild detergent that must be rinsed off.
- It is suggested to only clean with warm water and a soft cloth.
- Damage caused by the wrong cleaning methods used will void warranty.

**Coloured Finish:**

**2 Years** Matt Black. **5 Years** other finishes replacement product & parts.

**It is highly recommended an application of sealant at the base of the mixer to ensure a water tight seal.**